

BRACED WALL PANELS		
INDEX	MATERIAL	FASTENERS
①	BRWP PER R602.10.2 R602.10.4 TABLE R602.10.4 MIN. 3/8" O.C. PANEL 48" IN LENGTH	6d COMMON 6" EDGES/12" FIELD
②	ABWP PER R602.10.6.1 TABLE R602.10.5 BLKD # ALL EDGES	8d COMMON 6" EDGES/12" FIELD
③	1/2" GYP. BOARD, STUD MAX 24" O.C., 48" IN LENGTH-BOTH SIDES 96" IN LENGTH ONE SIDE	NAIL 1" O.C. SPEC. R602.3(1) Δ
④	PER R602.10.6 CONSTRUCTION OF METHODS ABW, PFH FFG, CS-FF AND BV-WSP	8d COMMON 6" EDGES/12" FIELD
⑤	3/8" OGB X 4'-0" 6d 4" O.C. EDGES 8" O.C. IN THE FIELD	8THD14

1. ALL WINDOW AND DOOR HEADERS ON LOAD BEARING WALLS TO BE (2) 2" X 12" NAILED TOGETHER OR EQUIVALENT UNLESS NOTED OTHERWISE.
2. BATHROOM WINDOWS TEMPERED IF LOWER THAN 60 INCHES FROM FINISH SHOWER FLOOR (PER R 308.4.5 2012 IRC.)
3. PROVIDE MIN. 100 SQUARE INCHES OF MAKEUP AIR FOR DRYER (PER G2439.4 (614.5) 2012 IRC)
4. FIRE BLOCKING SHALL COMPLY WITH IRC SECTION R602.8
5. ALL SILLS AND SOLE PLATES SHALL BE PRESSURE TREATED OR FOUNDATION GRADE REDWOOD. IRC SECTION R403.1.6
6. CEMENT, FIBER-CEMENT AN GLASS MAT GYPSUM BACKERS SHALL BE USED AS BACKERS FOR WALL TILE IN TUB AND SHOWER AREAS AND WALL PANELS IN SHOWER AREAS. SUCH WALL SURFACES SHALL EXTEND TO A HEIGHT OF NOT LESS THAN 6 FEET ABOVE FLOOR. R102.4.2 R301.2

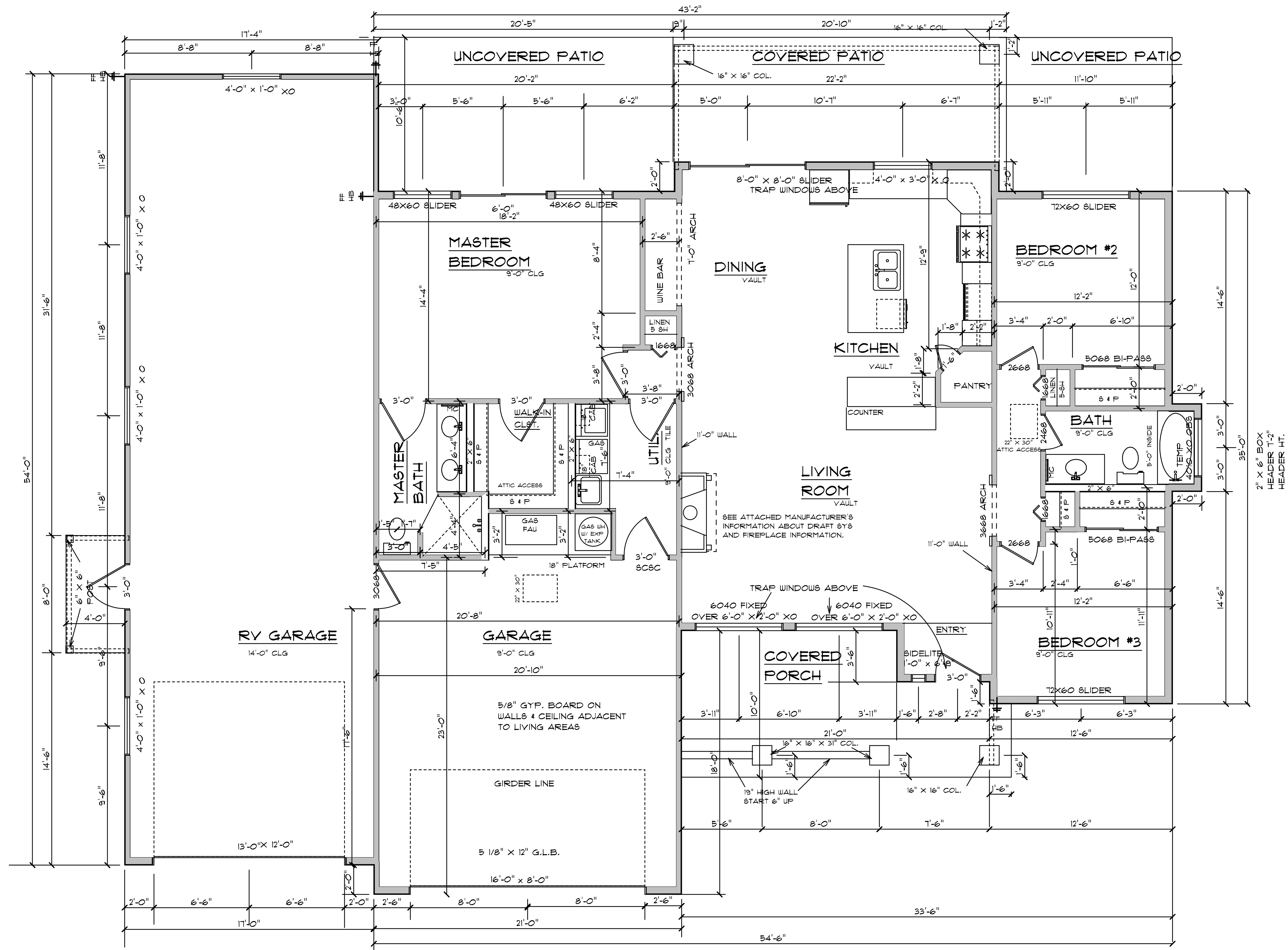

FLOOR PLAN

REVISION	BY

KANGAS RESIDENCE 1648 SQFT LIVABLE EDGEWOOD CONSTRUCTION

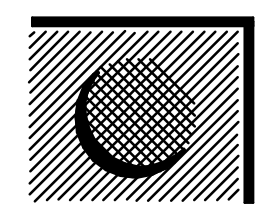

DRAWN BY BYB	
CHECKED BY	
DATE December 11, 2018	
SCALE	SHEET
JOB	3 OF 13